

4 CORE HOUSING OR CHECK VALVE



R-520

6185

R-520 (TR-CH-8) CORE HOUSING COMPLETE WITH CORE AND CAP

The R-520 is designated at Tire and Rim as the CH-8. It is an integral part of the system as the CH-8 is removed from the valve assembly with the Haltec IN-80A adapter to utilize the larger opening and the fullest flow.

6185 (TR-L-860) CHECK VALVE COMPLETE WITH CAP

The 6185 design permits rapid inflation and deflation. Eliminates need for core housing and inflation adapter. Used with 6190 air chuck.

6190 QUICK CONNECTION INFLATION CHUCK

Designed specifically for use with 6185 check valve. Sliding sleeve locks air chuck onto check valve and permits unrestricted air flow. Gauging can be done through valve on chuck. Positive air line shut off valve must be installed in back of air chuck.



6190



R-520B

R-520-B CORE HOUSING COMPLETE WITH CORE AND CAP

The R-520B is designated at Tire and Rim as the CH-8. It is an integral part of the system as the CH-8 is removed from the valve assembly with the Haltec IN-80A adapter to utilize the larger opening and the fullest flow.

A-150 CAP

Valve cap used on PT-style valves. 5/8" hex.

A-150



HT-R760



HT-R760 HIGH TEMP SLEEVE

High temp hose is used to protect R-760 in applications where temperatures are high enough to damage the R-760. The HT-760 is cut to length and slid over the R-760, then held in place with hose clamps.

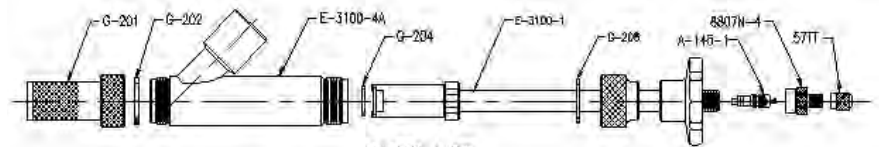

PARTS LIST

G-201	EJECTOR UNION	G-206	GASKET FOR G-207
G-202	GASKET FOR G-201	A-145-1	LARGE BORE VALVE CORE
E-3100-4A	ADAPTER BODY	8807N-4	CAP ADAPTER
G-204	SNAP RING FOR COLLET	57	STANDARD BORE CAP
E-3100-1	COMPLETE STEM AND COLLET		

IN-80A SUPER LARGE BORE INFLATOR ADAPTER

The Haltec design of the Super Large Bore inflator adapter offers many advantages.

- 1/2" pipe thread for easy air hose connection. During inflation, air pressure in the tire can be checked through the stem knob with a tire pressure gauge.
- Reduces inflation time 60%, deflation time 80%.
- The core housing is held in a stainless steel extractor by a snap ring.
- Extrator is rugged enough so that the core housing can be loosened or tightened without being damaged. The IN-80A inflator adapter saves time by fast inflation or deflation on a tire. After removing the valve cap, the inflator is screwed onto the valve stem. The inflator stem is pushed in to engage the flats on the core housing. By rotating the stem counter clockwise, the core housing can be removed without any danger to the person removing it. The core housing is pulled up into the inflator body and held there during inflation or deflation. Can also be used for liquid-filling tires equipped with Super Large Bore valves.



IN-80A

IN-80A PARTS LIST:

- G-201 Ejector Union
- E-3100-4A Adapter Body
- G-206 Gasket for E-3100-1
- 8807N-4 Cap Adapter
- E-3100-1 Complete Stem and Collet
- G-202 Gasket for G-201
- G-204 Snap Ring for Collet
- A-145 Large Bore Valve Core
- 57 Standard Bore Cap

SUPER LARGE BORE VALVES